



# Colburn & Guyette

Foodservice Designers & Consultants

## Gillette

Worcester, MA  
2007

- Employees – 1,200
- Seats - 350
- Seating – 5,600 sf.
- Kitchen / Serving – 4,000 sf.
- Equipment Cost - \$611,000
- Renovation to expand an existing Corporate Cafeteria.

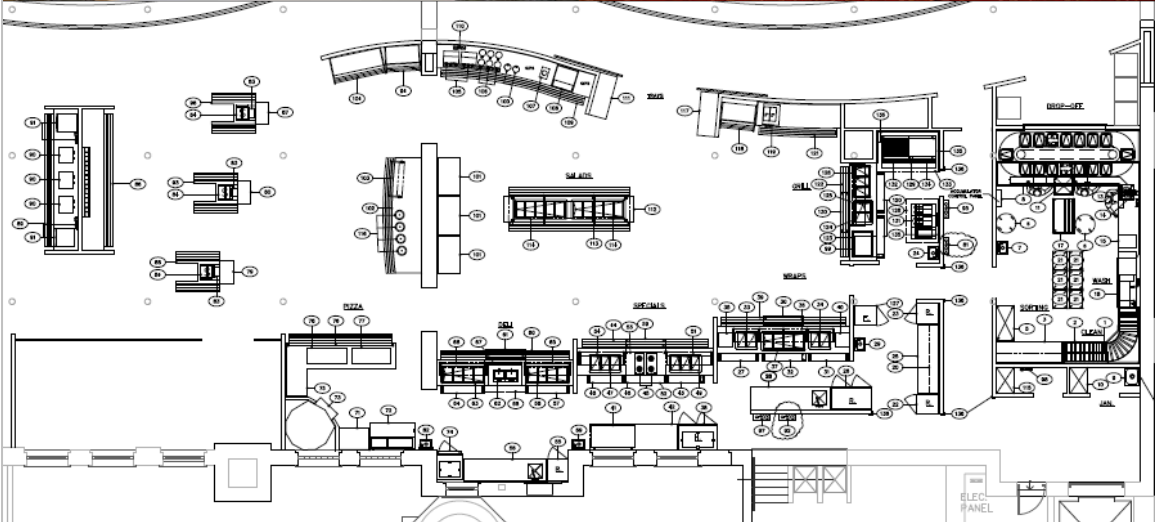



# Colburn & Guyette

Foodservice Designers & Consultants